







LEGENDA:

-  **Q.E.** Quadro elettrico che controlla i 10 fari teatrali + aperto/chiuso del sipario
-  **M.A.** Mixer audio 10 canali + lettori cd/dvd
-  Fari teatrali bianchi (n. 5 per parte)
-  Pannello in legno color naturale cm 100 x h 200 incernierati con sistema di aggancio a parete con saette (tutti i pannelli sono smontabili)
-  Pannello in legno color naturale cm 100 x h 200 con porta (dimensione apertura cm 58 x h 180)
-  Pannello in legno color naturale cm 100 x h 200 con finestra (dimensione finestra cm 47 x 47)

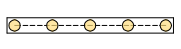
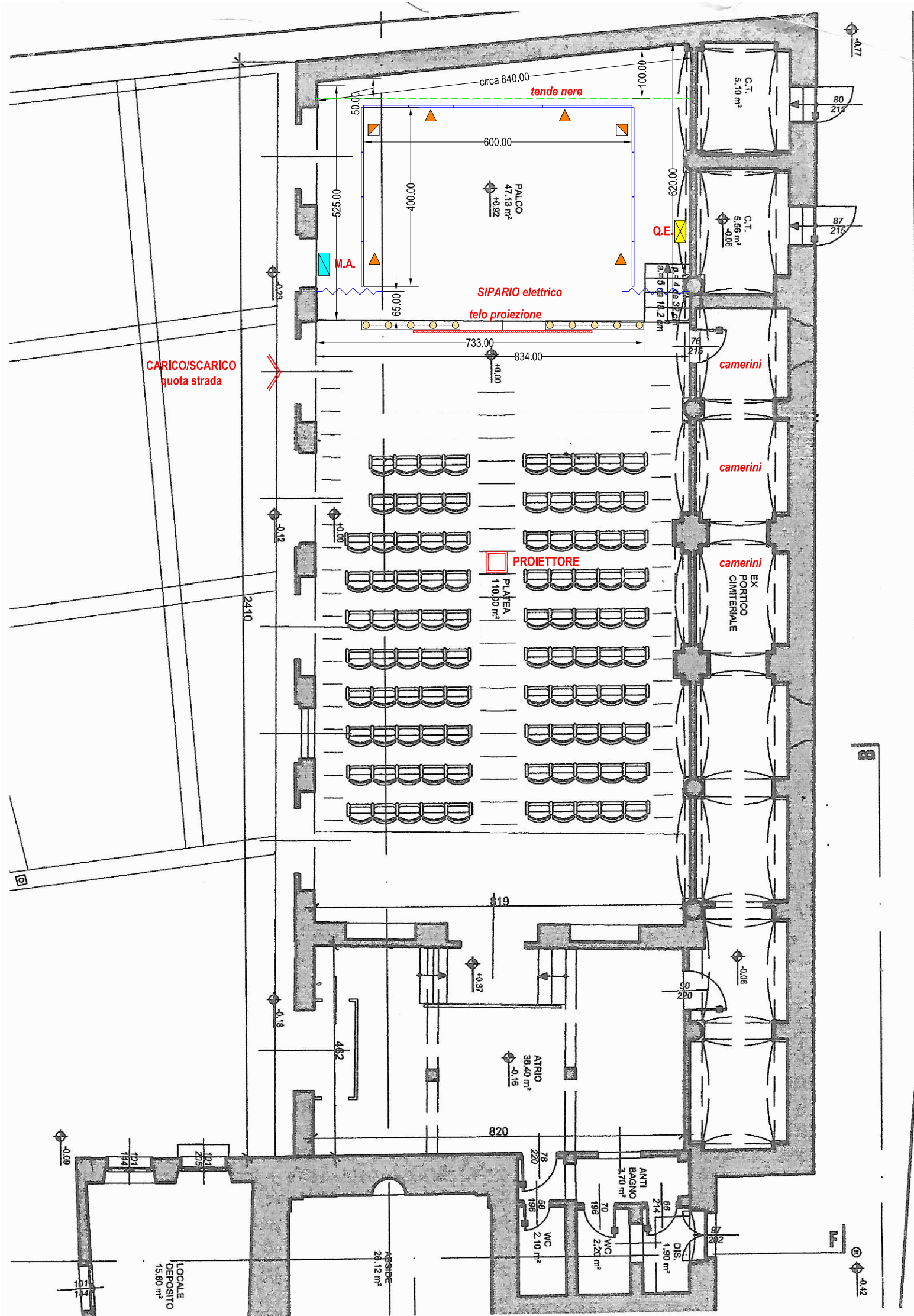

PLANIMETRIA TEATRO di PIEDIMULERA